

- NOTES:
- DO NOT SCALE. USE FIGURED DIMENSIONS ONLY.
 - THIS DRAWING IS TO BE READ IN CONJUNCTION WITH ALL OTHER RELEVANT ARCHITECTURAL AND ENGINEERING DRAWINGS.

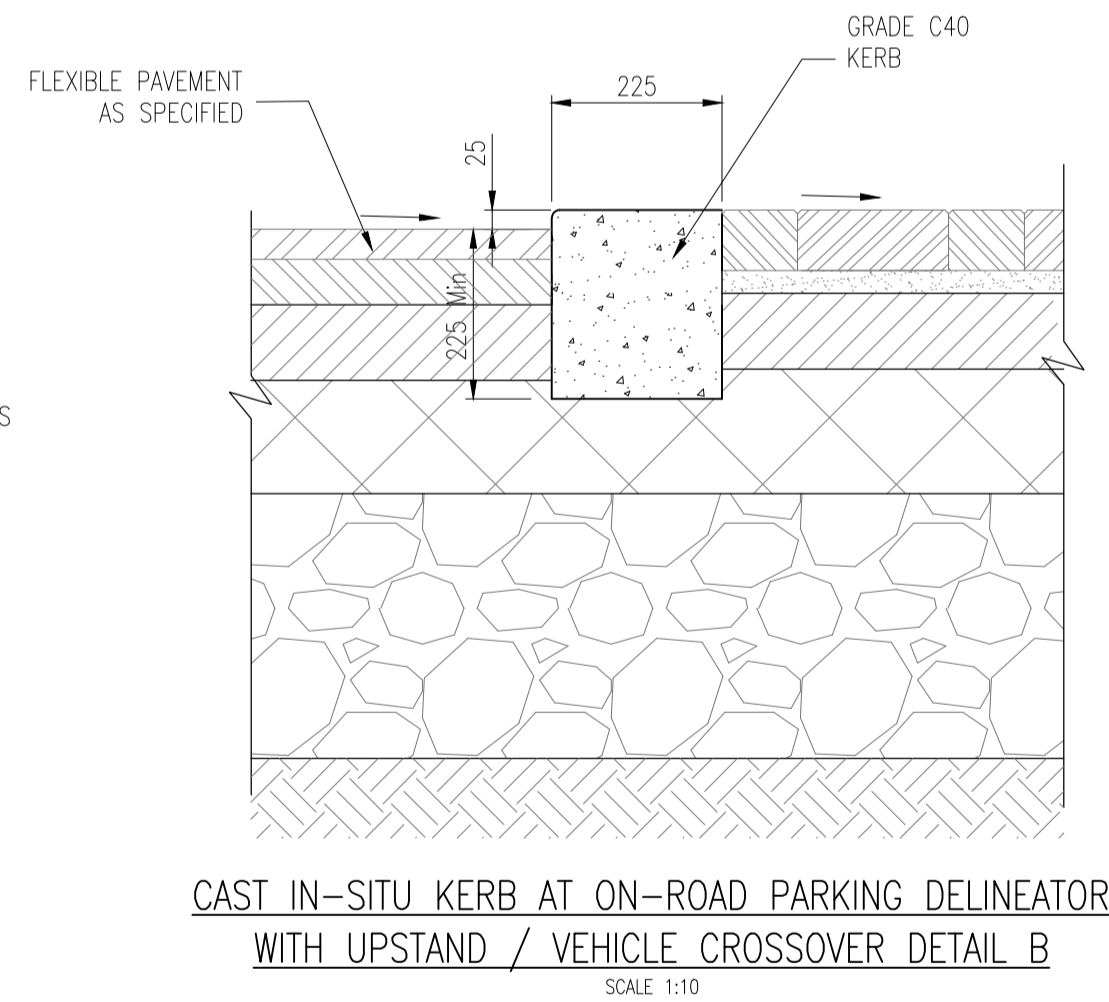
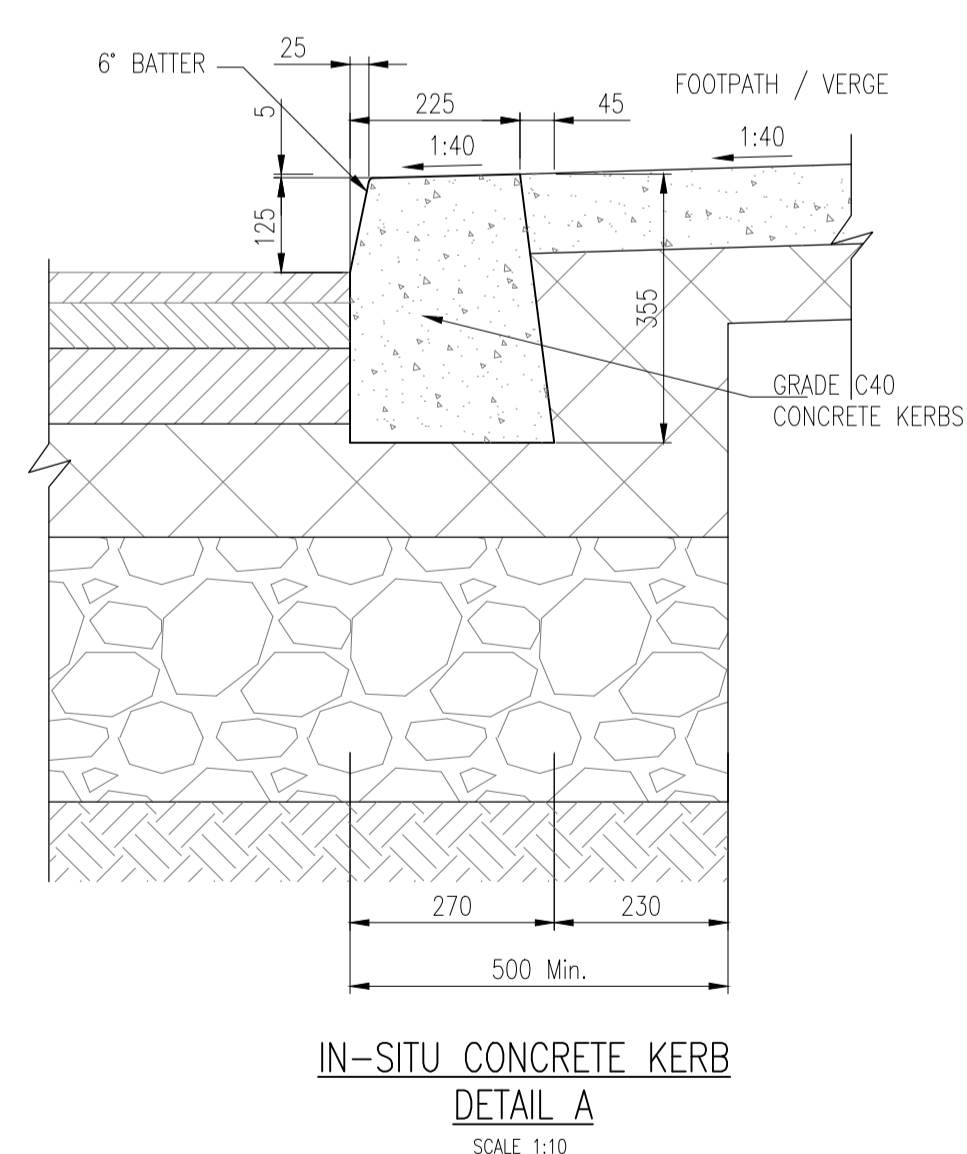
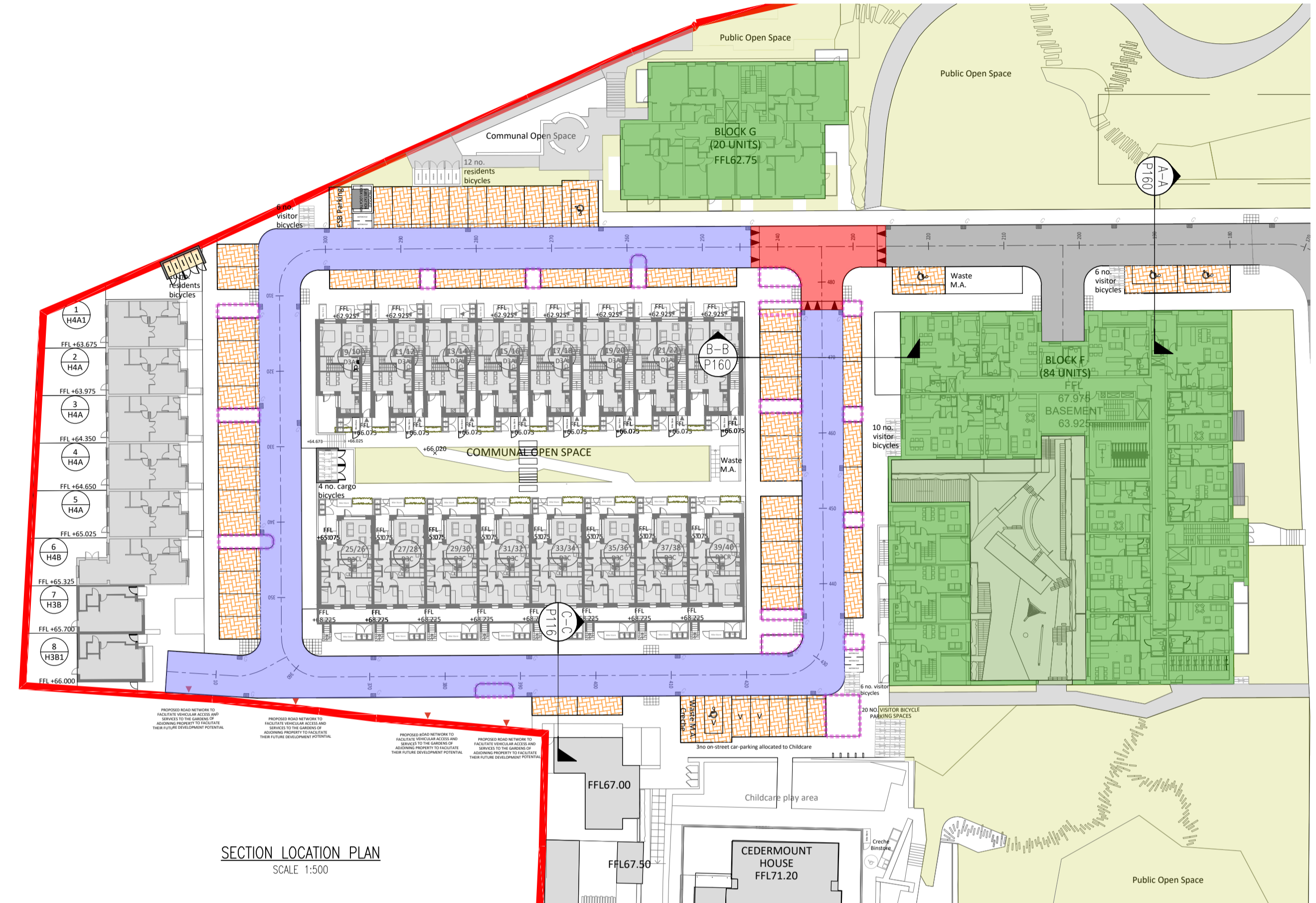
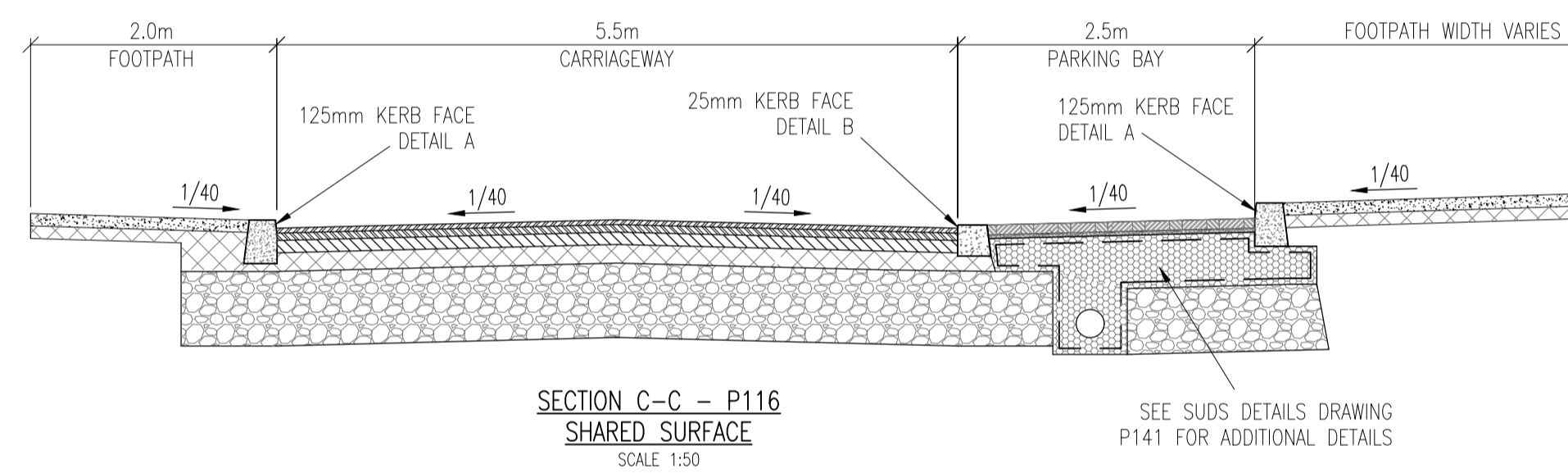
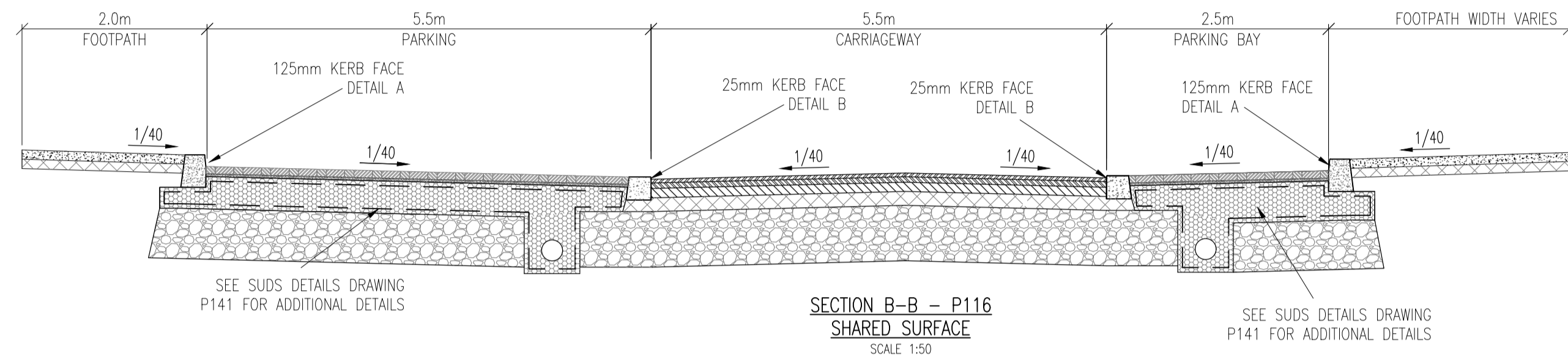
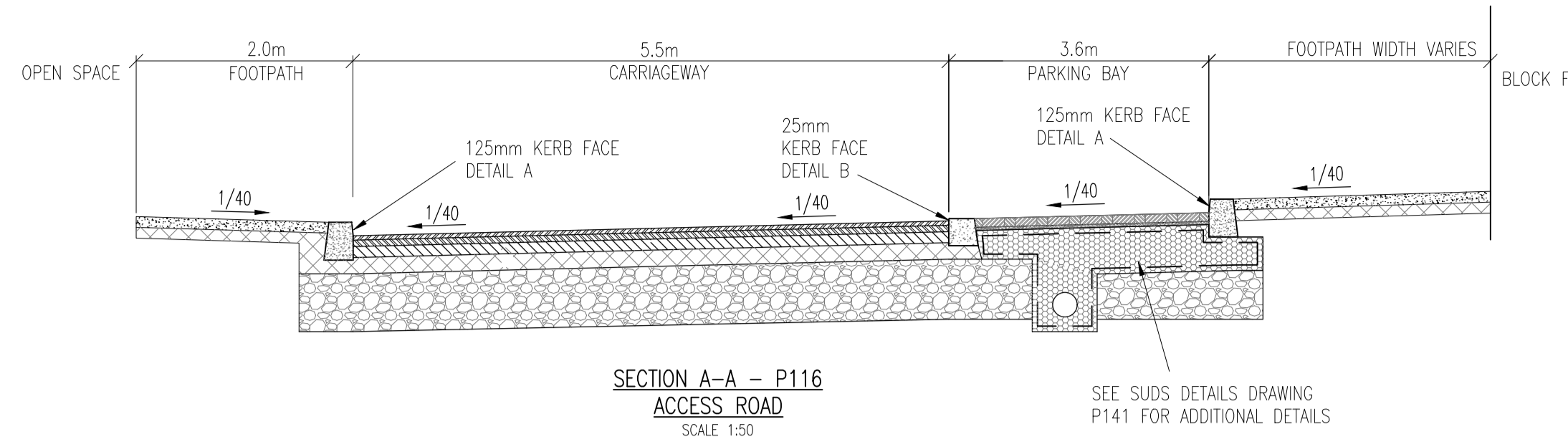

TABLE 1

C.B.R. SUB-GRADE (%)	BELOW 2	2	3	4 or More
THICKNESS OF SUB-BASE (mm)	625	475	350	300
SUB-BASE + CAPPING LAYER COMPRISING				
SUB-BASE THICKNESS (mm)	150		150	
CAPPING LAYER THICKNESS (mm)	600		350	

NOTE:- CAPPING LAYER THICKNESS
SITE INVESTIGATION CBR TEST RESULTS INDICATE CBR'S FROM 5.8 TO 8.5. ADDITIONAL TESTS TO BE CARRIED OUT BY THE CONTRACTOR TO BE TAKEN AT A RATE AGREED WITH THE ENGINEER BUT NOT LESS THAN 1 PER 50m.
ALL C.B.R. RESULTS TO BE SUBMITTED TO THE ENGINEER PRIOR TO LAYING SUB-BASE FOR APPROVAL.

ACCESS ROAD CONSTRUCTION:-
40mm SMA (PSV 70+) SURFACE COURSE ON
60mm BINDER COURSE - 20mm CHIP - AC20 DENSE BASE ON
80mm BINDER COURSE - 32mm CHIP - AC20 DENSE BASE ON
300mm MINI SUB-BASE - CLAUSE 808 GRANULAR MATERIAL NOTE:
THE DEPTH OF THIS SUB-BASE IS DEPENDENT UPON THE CBR OF
THE FORMATION. SEE TABLE 1.

FOOTWAY CONSTRUCTION
100mm CONCRETE ON
100mm GRANULAR FILL TO CLAUSE 808.
VEHICLE CROSSOVER CONSTRUCTION
150mm CONCRETE ON
150mm GRANULAR FILL TO CLAUSE 808

SHARED SURFACE CONSTRUCTION:-
AS PER ACCESS ROAD WITH BUFF COLOUR
SMA

- NOTE:
- U3 CONCRETE FINISH INSITU
 - CONCRETE KERBS SHALL COMPLY WITH THE RECOMMENDATIONS OF BS 5931 AND SHALL BE PROTECTED FROM ADVERSE WEATHER UNTIL CURED
 - EXPANSION AND CONSTRUCTION JOINTS IN KERB TO MATCH JOINTS IN ROADS AND FOOTWAYS
 - ALL ROAD WORKS TO BE TO DUN LAOCHAIRE COUNTY COUNCIL STANDARDS FOR TAKING IN CHARGE.

PARKING BAY CONSTRUCTION (FOR TAKING IN CHARGE):-
BLOCK PAVING TO BS7533-2 (CATEGORY II)
80mm BLOCK PAVING SURFACE COURSE
30mm BINDER COURSE - SAND
100mm BITUMINOUS BASE - CLOSE GRADED ASPHALT CONCRETE
350mm CAPPING LAYER NOTE: THE DEPTH OF THIS SUB-BASE IS DEPENDENT ON THE CBR OF THE FORMATION AND IS TO BE CONFIRMED ON SITE. SEE TABLE 1

A	18/10/2024	SUBMISSION OF APPLICATION	MS	JU
Rev	Date	Description	By	CHK
Amendments				
Project				
PHASE 2 RESIDENTIAL DEVELOPMENT AT KNOCKRABO, Mt. ANVILLE ROAD, DUBLIN 14				
Title				
ROAD CONSTRUCTION DETAILS				
Client				
KNOCKRABO INVESTMENTS DAC				
Status				
PLANNING				
Designed By	RM	Approved	MD	Waterman Ref
Drawn By	MS	Date	MAY 2024	20-086
Project - Originator - Volume - Level - Type - Rate - Number				Revision
KNB - WMC - PH2 - ZZ - DR - C - P116				A